

CASA DEL MAR Mallorca (Spain)

NEW BUILDING

- Client:** Hammaburg S.L., Spain
- Architects:** architecture design graphics ltd
Teich-Gruszka-Hennemann-Ruba+Partner,
Wuppertal
- Our services:** Full structural design
Establishing the basis
Preliminary design
Final design
Approval documentation
Execution drawings
Preparation of contract award
Construction supervision
- Brief description:** New building of three villas
- geometrically complex reinforced concrete structure consisting of columns, shear walls and flat slabs
- largely column-free room design
- steeply sloping site requiring absorption of earth pressure via a stiff box structure
- minimising of cracking through suitable reinforcement selection and design
- drainage of roofs through hollow steel columns
- increased concrete cover of reinforced concrete structure elements due to aggressive salty seaside air
- Completion:** 2012

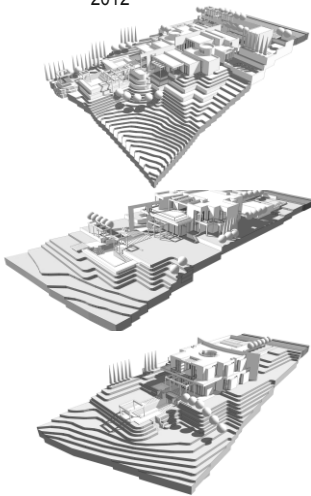

Pictures / Illustrations: ProfessorPfeiferandPartner PartGmbB, architecture design graphics ltd