

## RWE-TOWER AT THE AMIENS SQUARE Dortmund (Germany)

### NEW BUILDING

**Client:** Dreier Werke Dortmund

**Architects:** Gerber Architekten, Dortmund

**Our services:** Structural design  
Establishing the basis  
Preliminary design  
Alternatives and concept studies  
(in the stage of final design)

**Brief description:** New building of an administration centre  
- building height approx. 100 m  
- 25 storeys  
- thin flat slabs without beams, restrained in inner reinforced concrete core  
- on outer rim, slender reinforced concrete composite columns integrated into façade  
- bracing through centrally located core of reinforced concrete containing staircases, lifts and sanitary areas

**Completion:** 2009

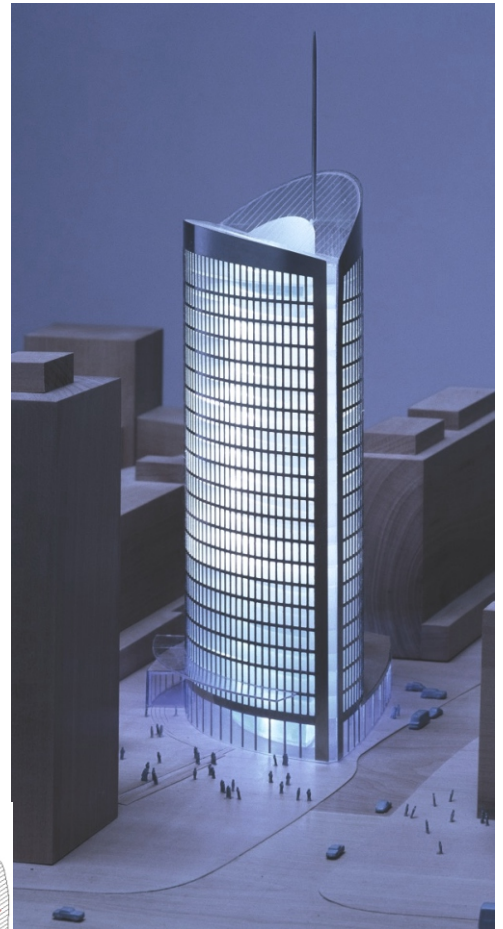

Architect model of the square tower

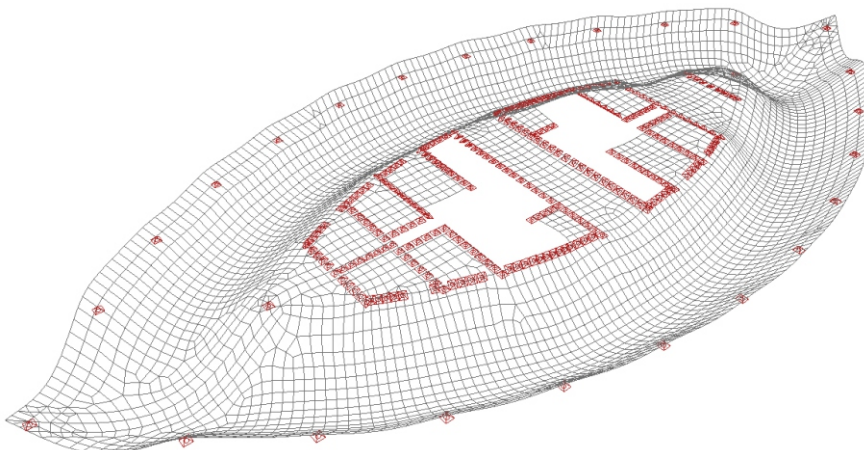

Typical flat slab with deflections

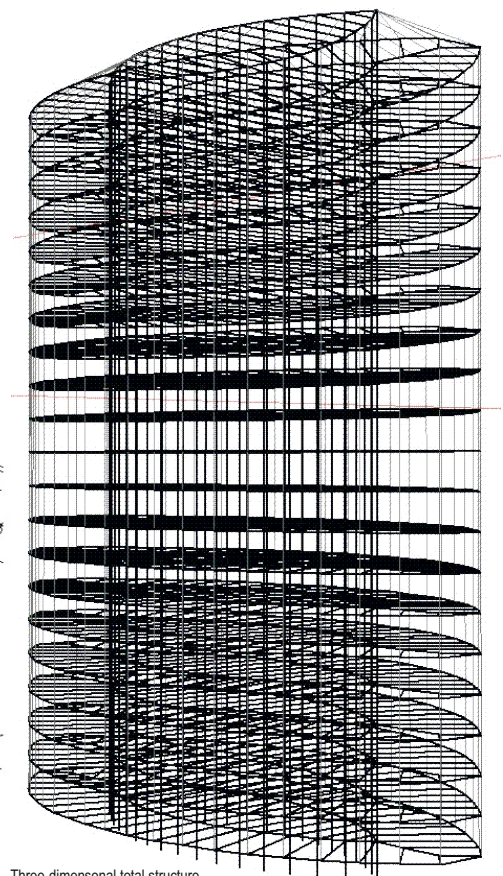
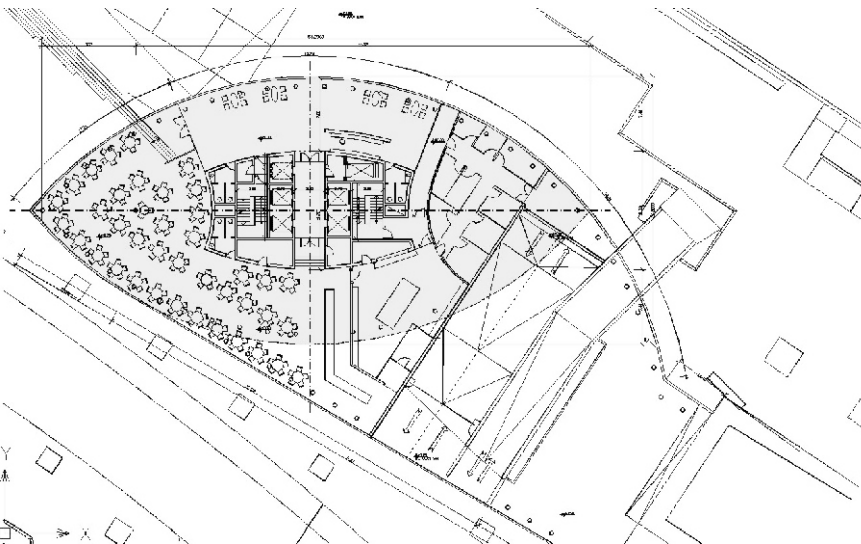

Three-dimensional total structure

Pictures / Illustrations: Professor Pfeifer and Partner PartGmbB, Gerber Architekten