

THE REPRESENTATION OF THE STATE OF HESSE Berlin (Germany)

NEW BUILDING

Client: Construction management of the State of Hesse,
western regional branch

Architects: Christl + Bruchhäuser Architekten,
Frankfurt/Main

Our services: Competition Consultancy (3. Prize)
Full structural design
Establishing the basis
Preliminary design
Final design
Approval documentation
Execution drawings
Preparation of contract award
Construction supervision
Structural fire protection
Thermal building physics

Brief description: New building of an administration complex
- very complicated, geometrically difficult
concrete and steel structure
- underground parking
- difficult underpinning
- very wide, partially multi-storey cantilevering

Completion: 2006



Plan of load transfer

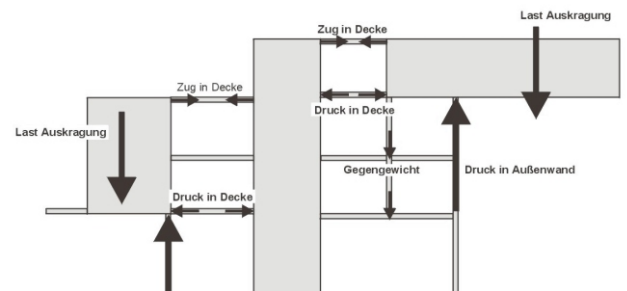

Plan of load transfer

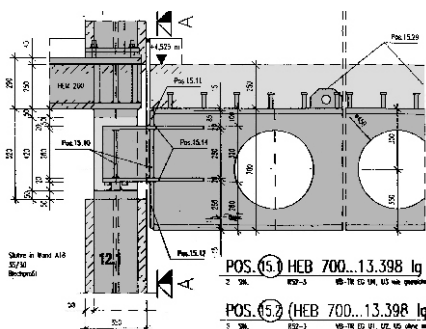

Pictures / Illustrations: Professor Pfeifer and Partner PartGmbH